



7075 State Route 88
Ravenna, OH 44266
Phone: (330) 296-2892
Fax: (330) 296-5680

Randy Griffith, Superintendent
Michelle E. Seckman, Treasurer

Welcome Back Seniors!

As your summer comes to an end, we are sure you are beginning to think about school and the start of your senior year. We enjoyed working with you last year and look forward to a very successful 2021-2022 school year. We know that your senior year at Maplewood will continue to be meaningful, productive, and fun. The instructors are excited to begin the year and look forward to greeting you soon.

- The first day of school will be Monday, August 30, at 8:12 a.m., and concluding at 2:26 p.m.
- Seniors will report to their lab first period on August 30, to pick up their schedule.
- Students need to use the same password as last year to purchase breakfast or lunch.
- Your 2020-2021 parking permits are still valid for the 2021-2022 school year. If your vehicle or plates have changed, please see Mrs. Finch in the High School Office.

Please complete the enclosed forms and turn them in to your program instructor on the first day of school.

Forms can also be completed and submitted at maplewoodcc-oh.finalforms.com

Instructions and more information about submitting forms online can be found on our website: www.mwood.cc

- Student Electronic/Internet Survey
- Authorization for Administering Prescription Medications, and Over-the-Counter Medications, (if needed to receive medication at school)
- Free and Reduced Price School Meals Application, if applicable (not available for online submission)
- Emergency Medical Authorization Form/Authorized Release (required by Ohio law)

We are all looking forward to a great year for everyone at Maplewood. Good things will happen to those who work hard and commit themselves to their education. We will see you on August 30!

With great expectations,

A handwritten signature in blue ink that reads 'Craig Morgan'.

Mr. Craig Morgan
Career and Technical
Director

Crestwood • Field • James A. Garfield
Mogadore • Ravenna • Rootstown • Southeast
Streetsboro • Waterloo • Windham
"Providing equal opportunity in education,
training, and employment"
www.mwood.cc



Calendar Information

While attending Maplewood, you will follow the Maplewood school calendar and **not** the calendar of your associate school. Contact your high school to obtain a copy of the school calendar to determine dates that Maplewood is in session and your associate school is not. Your associate school will provide transportation to and from Maplewood on those dates, but they will NOT run the normal routes to pick up/drop off students at their homes.

On the following dates Maplewood is in session but the associate school is not:

Crestwood – October 29, November 24, January 21, February 18, March 28, 29, 30, 31, April 1

Field – August 30, November 1, 2, January 3, 4, February 17, 18, March 18, April 11-14, May 3

Garfield – October 29, January 14, April 11-14, June 3, 6, 7

Mogadore – November 1, 24, March 28 – 31, April 1, June 6,7

Ravenna – November 2, January 14, February 18, April 11-14, 18, May 27, 31, June 1-3, 6, 7

Rootstown – September 24, February 18, March 28 – 31, April 1, June 6, 7

Southeast – August 30, September 17, November 24, January 3, February 18, April 14, 18, June 6, 7

Streetsboro – October 11, November 24, January 3, February 18, April 18, May 31, June 1-3, 6, 7

Waterloo – October 11, November 24, February 18, March 28-31, April 1

Windham – November 24, January 3, February 18, April 18, May 3, 27, 31, June 1-3, 6, 7

- Students are to follow the Maplewood Career Center school calendar.
- Contact your associate school to verify the dates of conflict.
- Students will not be excused for lack of transportation.



Student/Parent Information Sheet

BUS SERVICE:

Bus service to and from Maplewood is provided by each of the home schools. **If you have any questions concerning transportation, contact your home school bus garage.**

STUDENT DRIVER:

Students must show their license plate registration and pay \$1.00 to register their vehicle and secure a driving permit from the High School Office. Permits must be displayed by September 17, in order to avoid negative consequences. Cars may be registered throughout the year. More information will be available in your Student Handbook. **All students will park in the north parking lot.**

STUDENT DROP-OFF/PICK-UP:

Please see the attached sheet for specific locations for student drop-off and pick-up.

CREDIT FLEXIBILITY:

Maplewood participates in the state required credit flexibility program.

COLLEGE PLUS CREDIT:

Maplewood students are permitted to participate in the College Credit Plus program.

LUNCH INFORMATION:

Maplewood Career Center will be participating in the Free Lunch Program again this year. All students are eligible for both free breakfast and free lunch. A la carte items will be available for purchase. Parents/Guardians are asked to complete the Free and Reduced Lunch application to determine eligibility for reduced tool kit pricing.

Maplewood Career Center uses computerized Point of Sale (POS) software in the cafeteria for purchases at both breakfast and lunch services. Cash is still accepted, however, students are required to enter their password for all purchases whether they are paying with cash or using money from their account.

Parents/guardians may deposit money into the student's account by sending a check or cash to the main office. Please include the student's name and account number with all deposits. Students will not be permitted to charge items to their account unless there are sufficient funds in the account.

If you have any questions please contact Mr. Joe Hinton, Cafeteria Supervisor, at 330.296.2892 ext. 551503.

STUDENT ACCIDENT INSURANCE:

Students who are interested in Student Accident Insurance through Guarantee Trust Life can visit www.gtlic.com for more information and to purchase the insurance.

Maplewood Career Center

Morning student drop off procedure

Students are to be dropped off in the morning by the corner of the staff parking lot and students will enter through the main doors under the canopy. Due to the fact that our student drivers must circle the building, do not drop off students at the south end of the building. See map below.

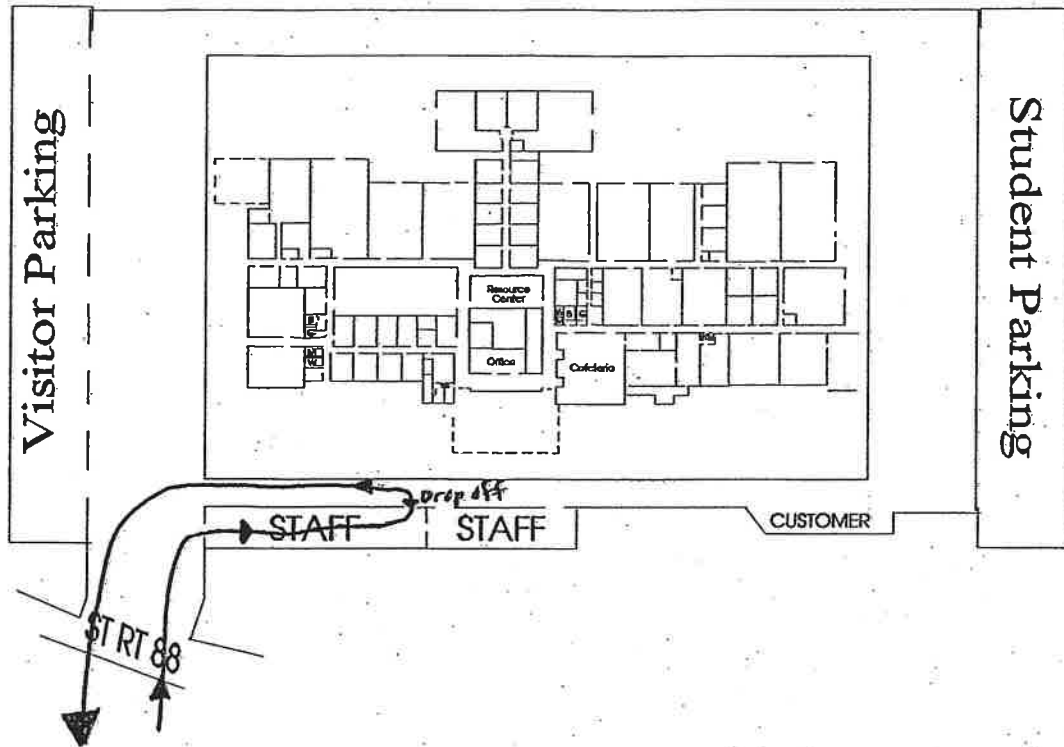

Afternoon student pick up procedure

Students who are being picked up at the conclusion of the school day are to be picked up in the south parking (Visitor Parking) lot. Parents, relatives, and friends must wait in their vehicle for the student to arrive in the lot. After the student is picked up, follow the instructions of the parking lot monitors for exiting

